

1 MARK DOOR

Select 2 3/8" (60mm) or 2 3/4" (70mm) from backset template and mark center of hole on door face. (Templates provided).

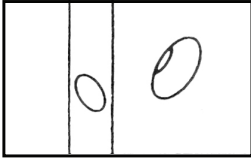

2 DRILL HOLES

Drill 2 1/8" (54mm) hole on door face. Drill 1" (25.4mm) hole in door edge for the deadbolt latch.

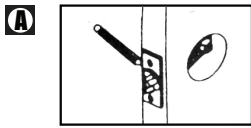

3 INSTALL LATCH

(A) Insert latch in hole and keep it parallel to door face. Mark outline of face plate and remove latch.

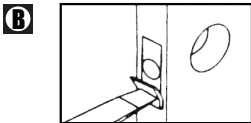

(B) Chisel 1/8" (3mm) deep or until face plate is flush with door edge.

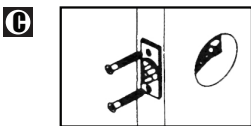

(C) Insert latch and tighten screws.

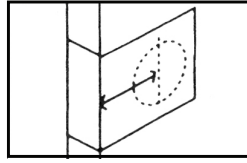

5 VERIFY BACKSET

- (1) Verify that backset is a distance from door edge to center of hole on door face.
- (2) All locks are supplied with adjustable latches which fit 2 3/8" (60mm) or 2 3/4" (70mm) backsets.

NOTE: Default latch setting is for 2 3/8" (60mm) backset.

6 ADJUST LATCH FOR 2 3/4" (70mm) BACKSET

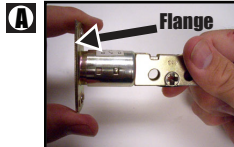

(A) Latch set for 2 3/8" (60mm) backset.

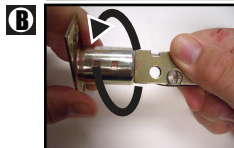

(B) Twist flange toward you.

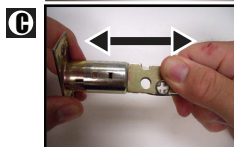

(C) Pull flange out.

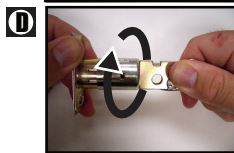

(D) Twist flange away from you to set 2 3/4" (70mm) backset.

NOTE: Ensure that the bolt is flush with flange at during all settings.

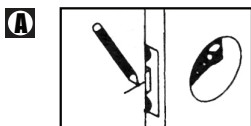

4 INSTALL STRIKE PLATE

(A) Close door and mark latch centerline on door frame. Extend mark through door frame thickness. Mark at the center of door frame.

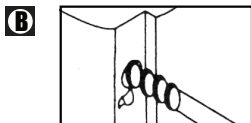

(B) Drill 1" (25.4mm) hole 1/2" (13mm) deep in door frame.

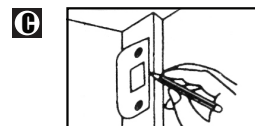

(C) Outline the strike plate on door frame then chisel 1/16" (1.6mm) deep for a flush fit. Mount strike plate on door frame.

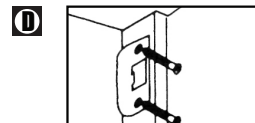

(D) Adjustable tang on strike permits bending in or out to eliminate too loose fit between door and door stop.

CAUTION: To insure proper lockset function, hole jamb must be drilled a full 1/2" (13mm) deep.